

# Quantum100™

## 100mm Linear TMR Position Sensors



The Quantum100™ sensor is a robust, lightweight linear position sensor with a 100mm measurement range. The non-contact TMR sensor provides extremely accurate position measurement in harsh environmental applications. Standard motorsport measurement applications include: hydraulic piston travel, suspension component monitoring, steering position and throttle position sensing. The sensor outputs its measurement via a digital CAN output or analogue voltage output.

### Sensor Dimensions

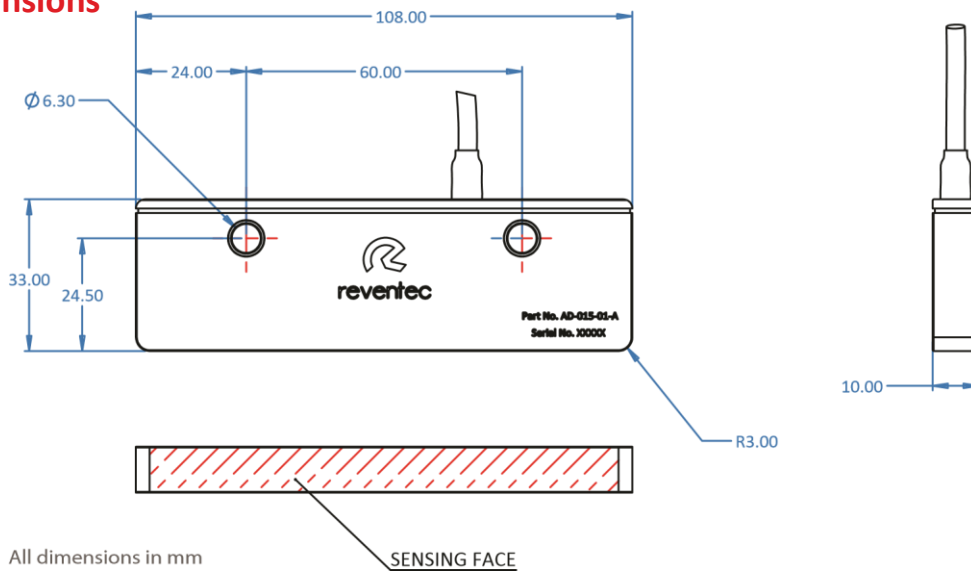

### Typical Target Dimensions

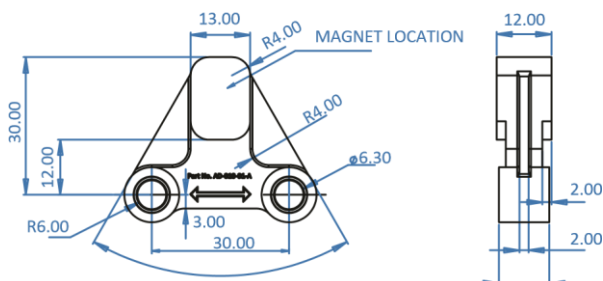

### Mechanical Configuration

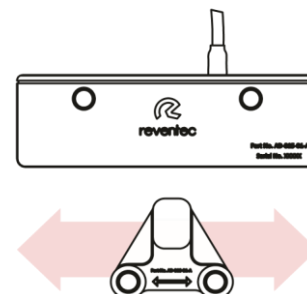



## Measurement

Type	Angular and Linear Displacement
Typical Accuracy	±0.5% of measurement
Measurement Rate	5kHz
Measurement Range	±50mm linear

## CAN Output

Type	CAN 2.0A
Baud Rate	500kbit/sec or 1MegB/s
Message Output Rate	1kHz, 100Hz or 10Hz
Message Format	Please contact us for more detail.

## Electrical

Supply Voltage	+6VDC to +40VDC
Typical Operating Current	<12mA at +12VDC
Overvoltage Protection	+45 VDC continuous
Reverse Polarity Protection	-45 VDC continuous

## Mechanical

Construction Material	Anodised Aluminium, Stainless-Steel, Titanium, PEEK or a combination
Mass	From 15g

## Analogue Output

Type	Voltage
Voltage Output Range	0-5V or 0-10V
Typical Output Calibration	+0.5V to +4.5V (Fully Configurable)
Resolution	12 bit
Output Temperature Stability	±0.1% over full temperature range

## Wiring Specification

Connector Options	Flying lead. Deutsch ASL 5 Way Connector Deutsch ASX 5 Way Connector Custom (Contact Us)
Sleeve Elastomer	To customer specification; Typically DR-25 or RW-200E
Boot Elastomer	Viton FEP
Wire Type	5 core, Type 55, 26 AWG or 28AWG

## Dimensions

Sensor	Customer Specific
--------	-------------------

## Environmental

Environmental protection	IP67
Vibration	Designed to meet: 10Hz to 2000Hz sine sweep @10G (24hrs per each axis)
Shock	Designed to meet: 50G half sine wave for 11ms, 10 times each axis
Remote Sensing Head Operating Temperature	-40°C to +150°C
Processing Electronics Operating Temperature	-40°C to +125°C

## Typical Wiring Definition

Description	Wire Colour	Pin Out
Supply (+)	Red	1
Ground (GND)	Black	2
Signal (0.25-4.75V)	Yellow	3
Tx Comms (Transmit)	White	4
Rx Comms (Receive)	Green	5

## Accessories

USB calibration cable	P/N: 07-003-01
-----------------------	----------------

## Configuration Interface

Type	RS-232 via FTDI USB cable. See accessories
GUI	Available on request

Specifications may be subject to change without prior notice